

# FM-200 COMPONENT DESCRIPTION

## Pilot Actuation Fittings

F-93-5040

**FENWAL®**

### FEATURES

- *FOR USE WITH UL LISTED, ULC LISTED & FMRC APPROVED SYSTEMS*

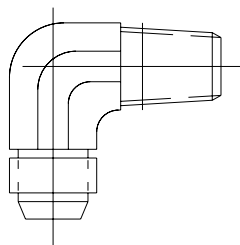

**MALE ELBOW**  
**1/8" NPT X 5/16" TUBING**  
**P/N 6992-0503**

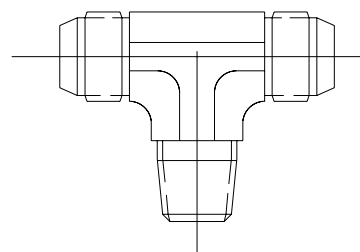

**MALE BRANCH TEE**  
**1/8" NPT X 5/16" TUBING**  
**P/N 6992-0505**

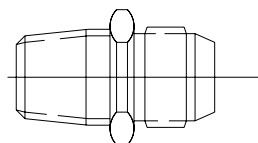

**MALE CONNECTOR**  
**1/8" NPT X 5/16" TUBING**  
**P/N 6992-0501**

**MATERIAL: BRASS**

**FENWAL®**

KIDDE-FENWAL, INC.  
 400 MAIN STREET, ASHLAND, MA 01721  
 TEL: (508) 881-2000 FAX: (508) 881-8920  
 www.fenwalfire.com



This literature is provided for informational purposes only. KIDDE-FENWAL, INC. assumes no responsibility for the product's suitability for a particular application. The product must be properly applied to perform as described herein. If you need more information on this product, or if you have a question, contact KIDDE-FENWAL, INC., Ashland, MA 01721; Telephone (508) 881-2000